

2007 KMI Mine Rescue Contest

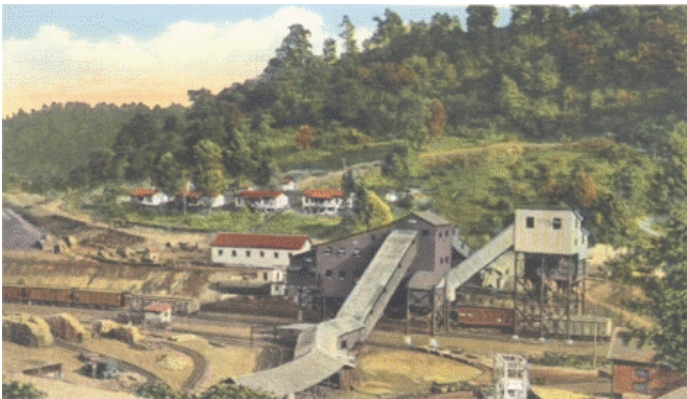
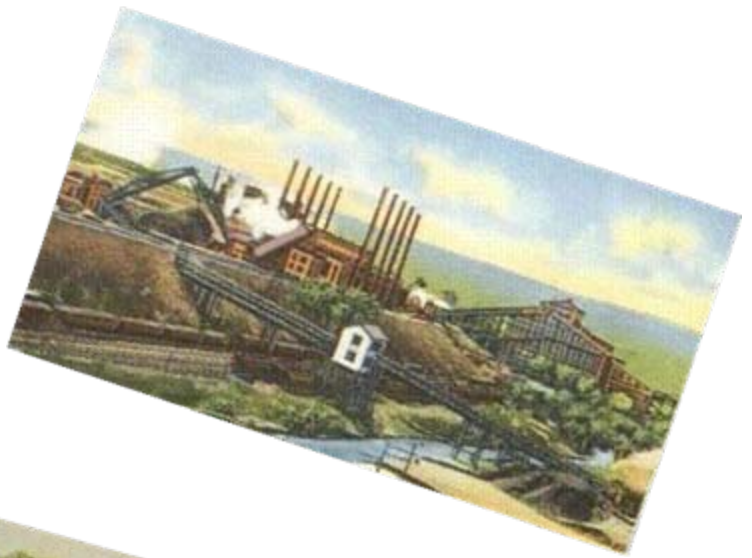

JUDGES BRIEFING

AUGUST 15TH

Statement

I am _____, Superintendent of the Waterloo No.2 Mine. Thank you for answering our call for help.

Early this morning, (six) 6 men entered the mine to work on seals and support the roof. At 5:00 am, an explosion was heard and the exhaust fan stopped. All attempts to reach the crew have been unsuccessful . All (Six) 6 miners are still missing.

I traveled into the No. 1 and No. 2 entry and found water everywhere. A high concentration of methane was in the No. 3 entry, so I came back outside to call for help.

A fresh air base has been set up in this first crosscut and all areas outby this location have been made. The exhaust fan is off, but can be turned on by the backup team.

Waterloo No. 2 mine is a highwall mines that was sealed about 3 crosscuts inby the highwall. This mine cut into an unsealed abandoned mine a few months ago. Work is being done to try to get this mine back in operation as soon as possible.

This mine also has problems with water, bad roof and methane. The mine maps are not up to date.

All electrical circuits going into the mines have been de-energized, locked out and guarded.

We have a competent lifeline person to give and return signals (point this person out)

We have a backup team (with ventilation structure materials) that can only do the following: start, stop and reverse the fan if needed, close and open the explosion door at the fan, and build and remove stoppings in No.1 and No.2 entry just inside the mine.

Each request for work by the backup team will take 2 minutes. Extra maps will be provided for you and your team to mark changes for backup team work. You and your team will be responsible for stoppings built in this first crosscut, but all work outby this crosscut must be done by the backup team.

Written instructions and mine maps will be given to you when the clock is started

Thank you and your team for your assistance !

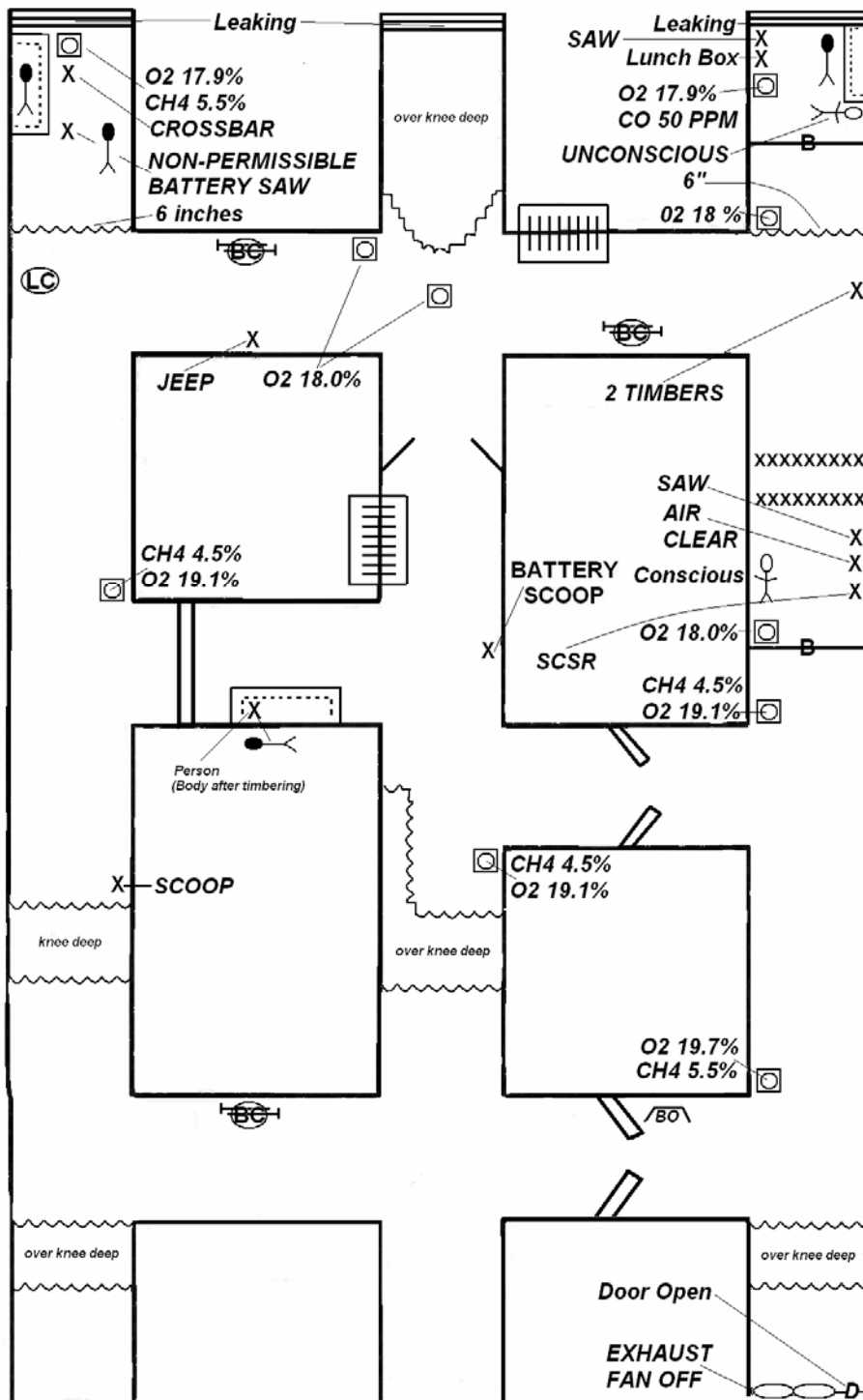
KMI 2007

KMI Mine Rescue Contest

Problem

(Written Instructions)

ACCOUNT FOR ALL MISSING
PERSONS

EXPLORE THE ENTIRE MINE IF IT
CAN BE DONE SAFELY

THE SEAL IN THE NO.1 ENTRY IS
ONE CROSSCUT OUTBY AN OLD
AIR SHAFT. THE OLD SHAFT
MUST NOT BE USED FOR
VENTILATION

Team Map

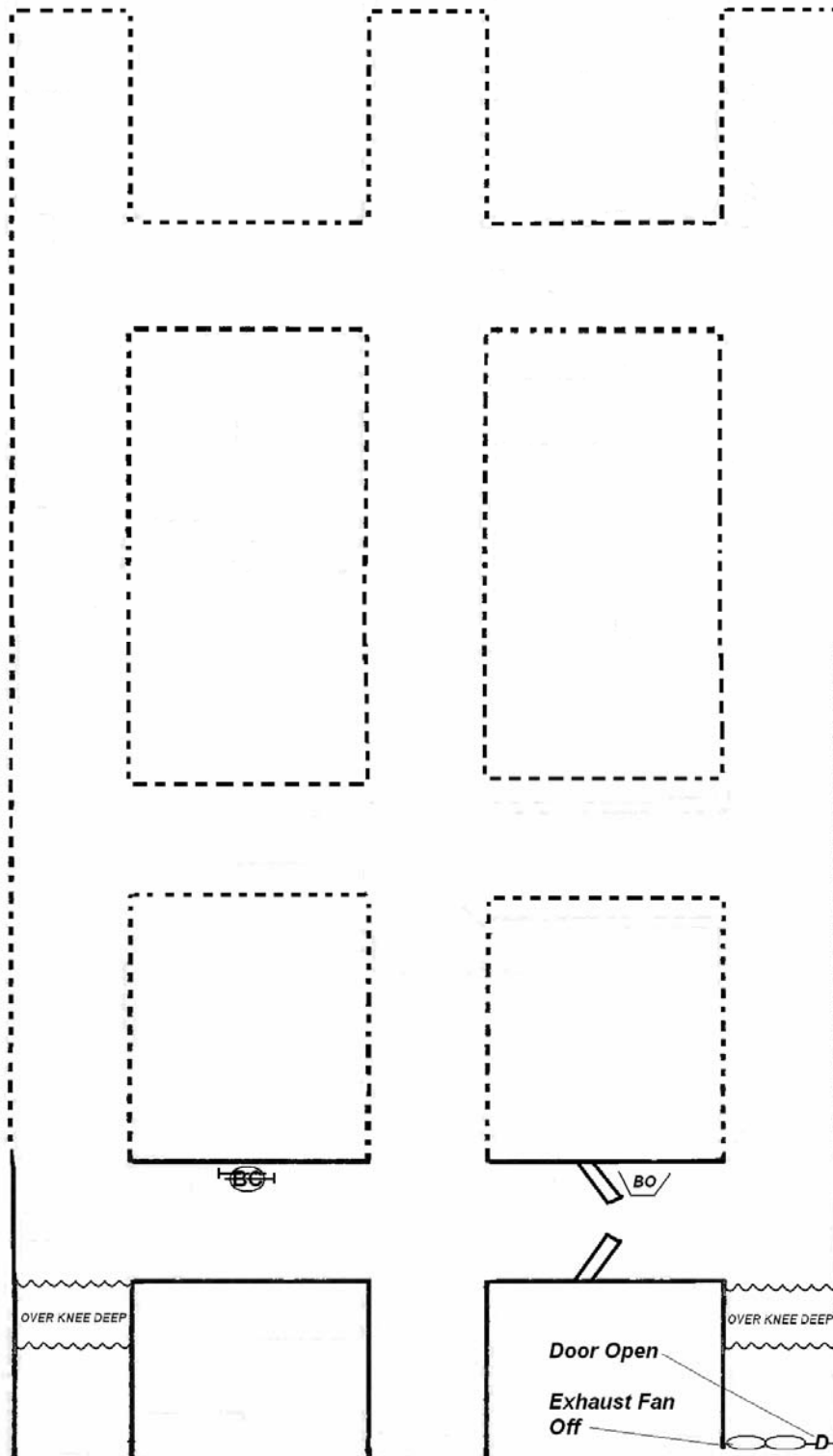

OUTBY Map

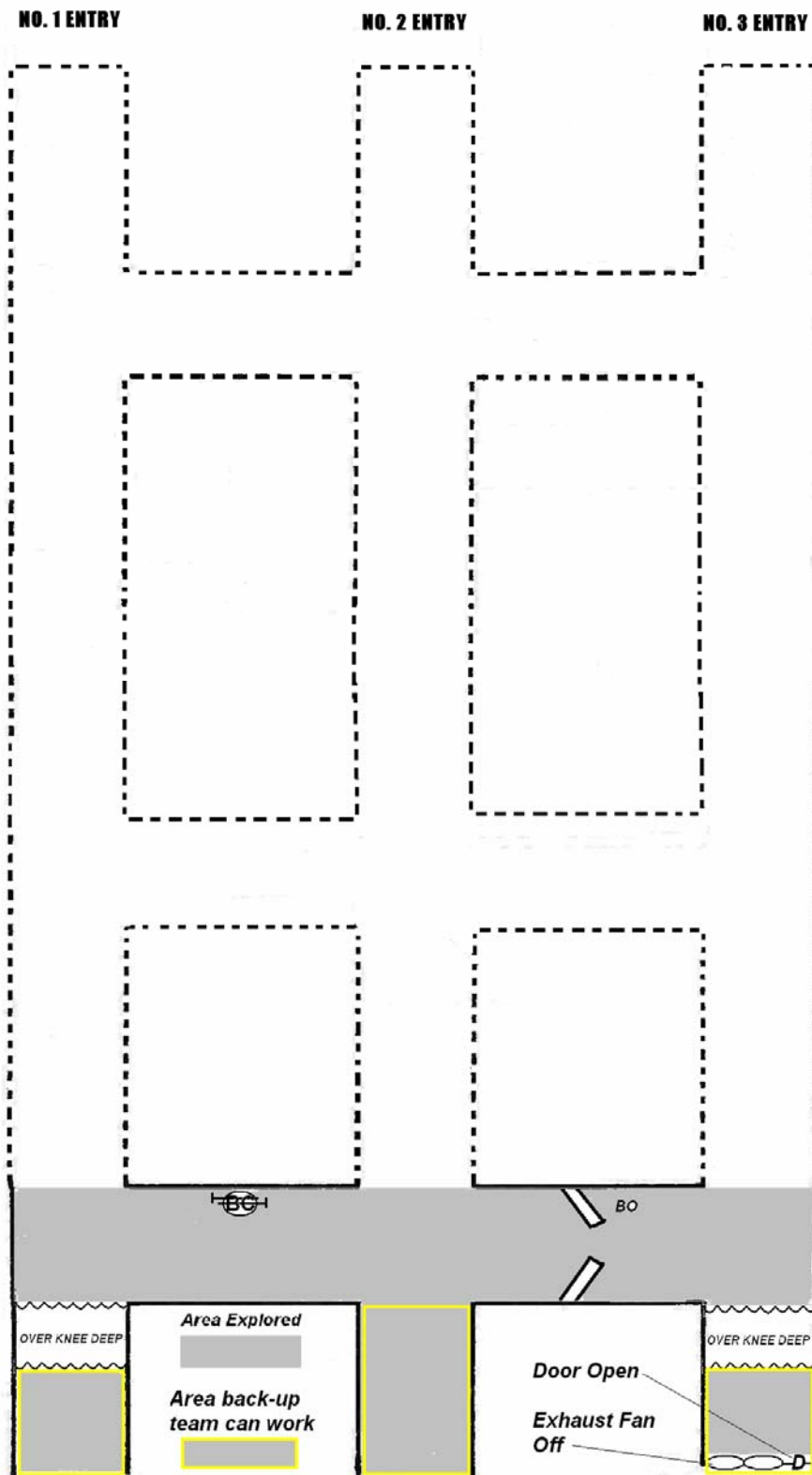

KMI 2007 TEAM STOPS

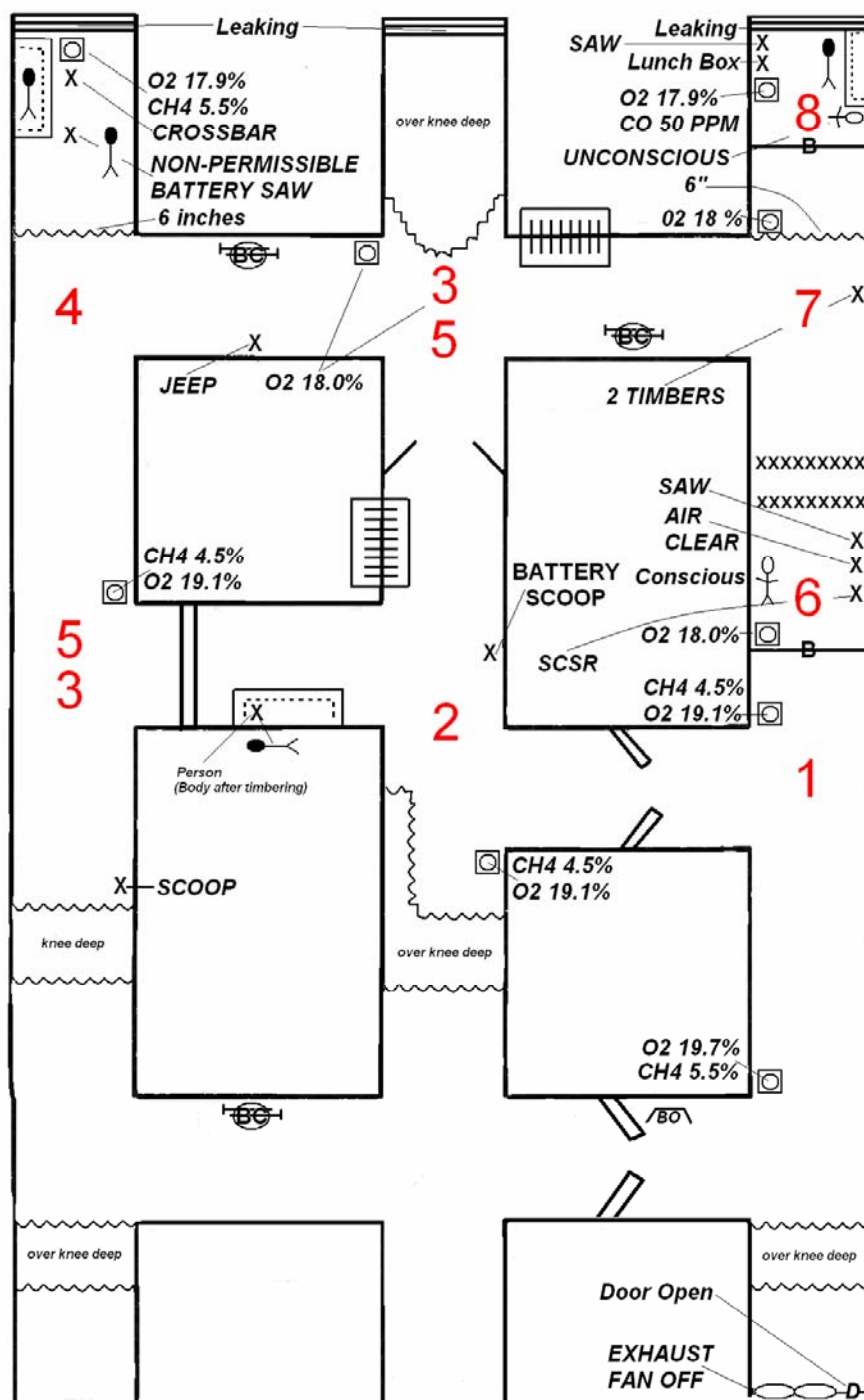

KMI 2007

ROOF & RIB D&I GAS TEST

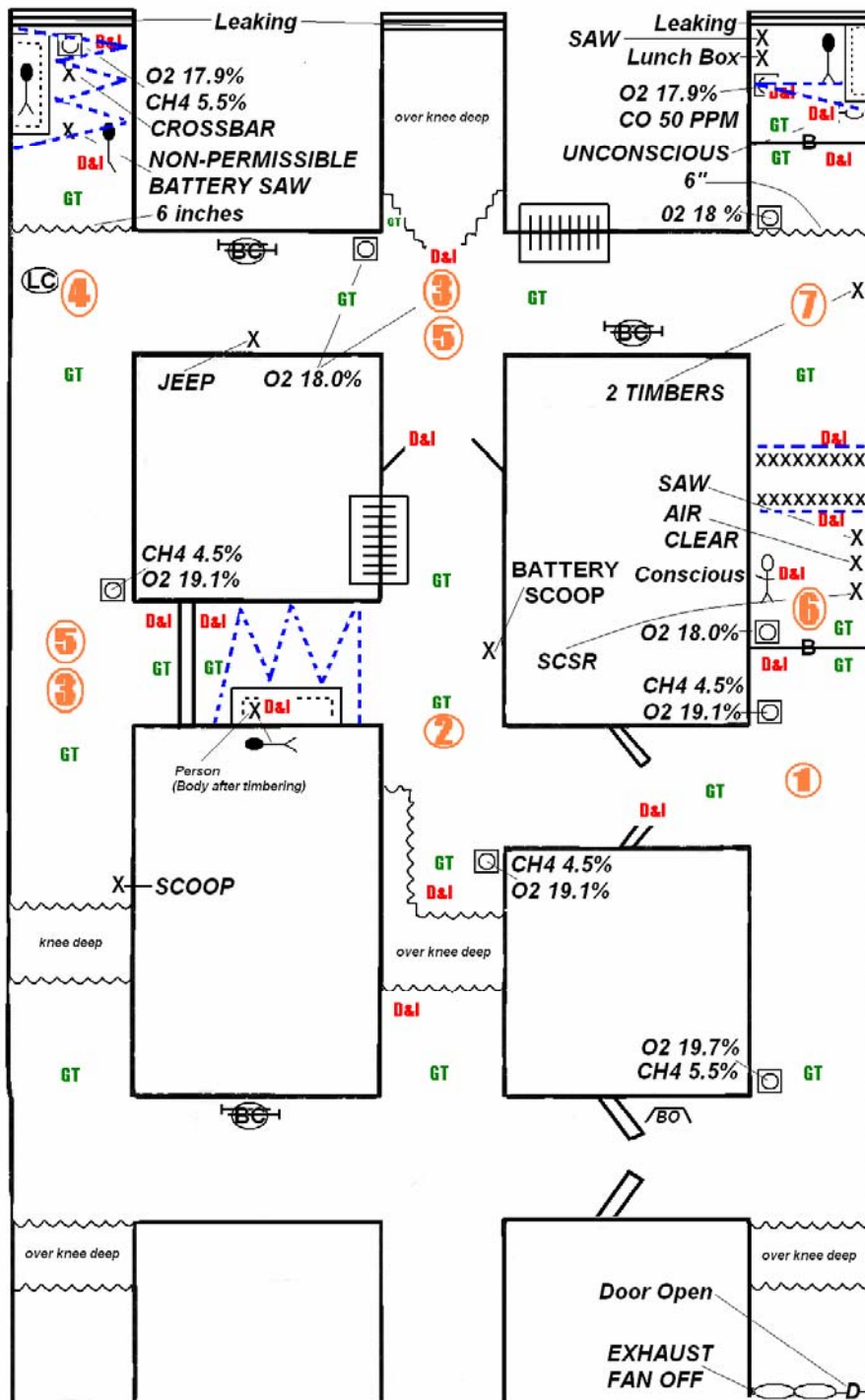

Extent of Gases

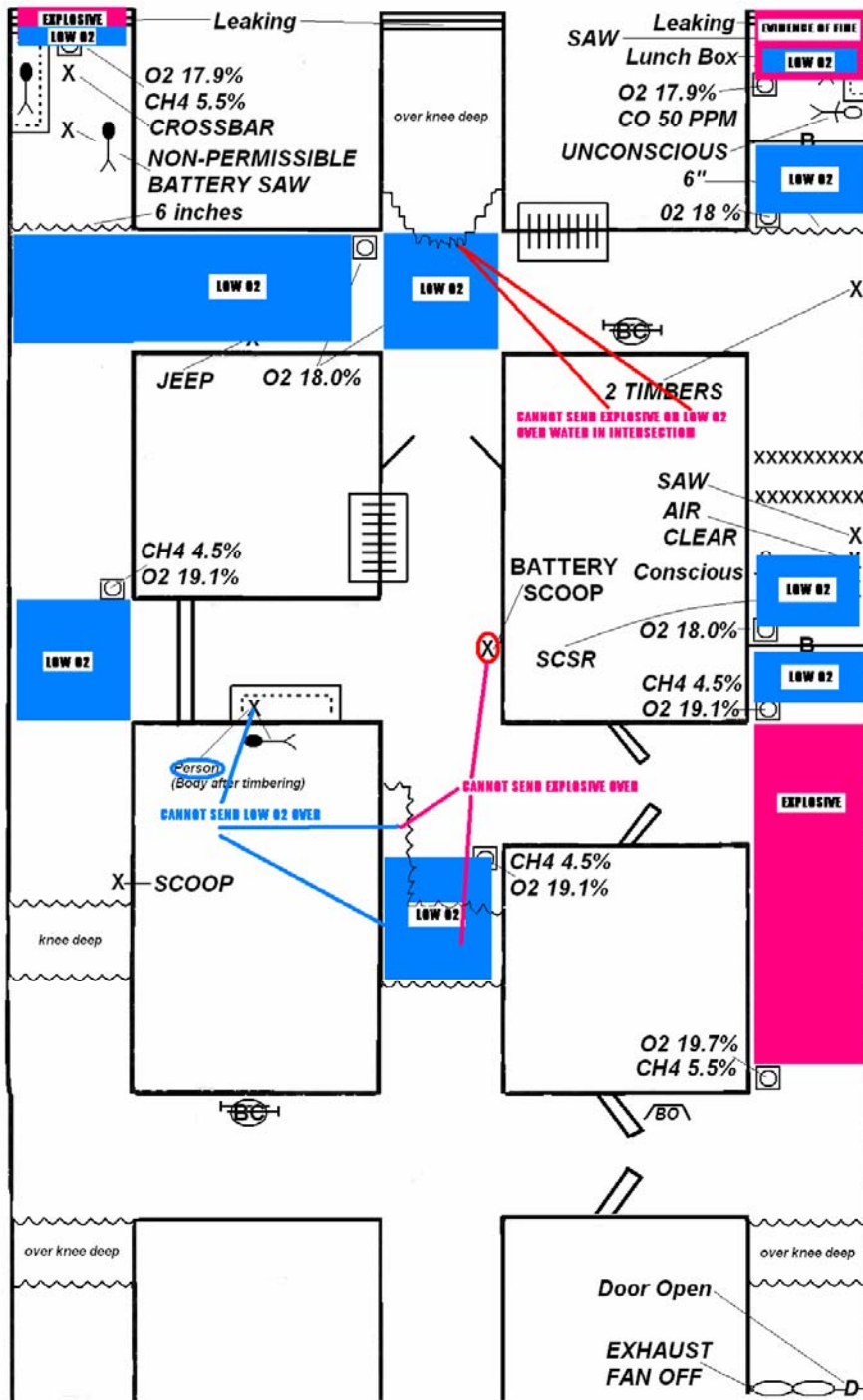

FIRST VENTILATION

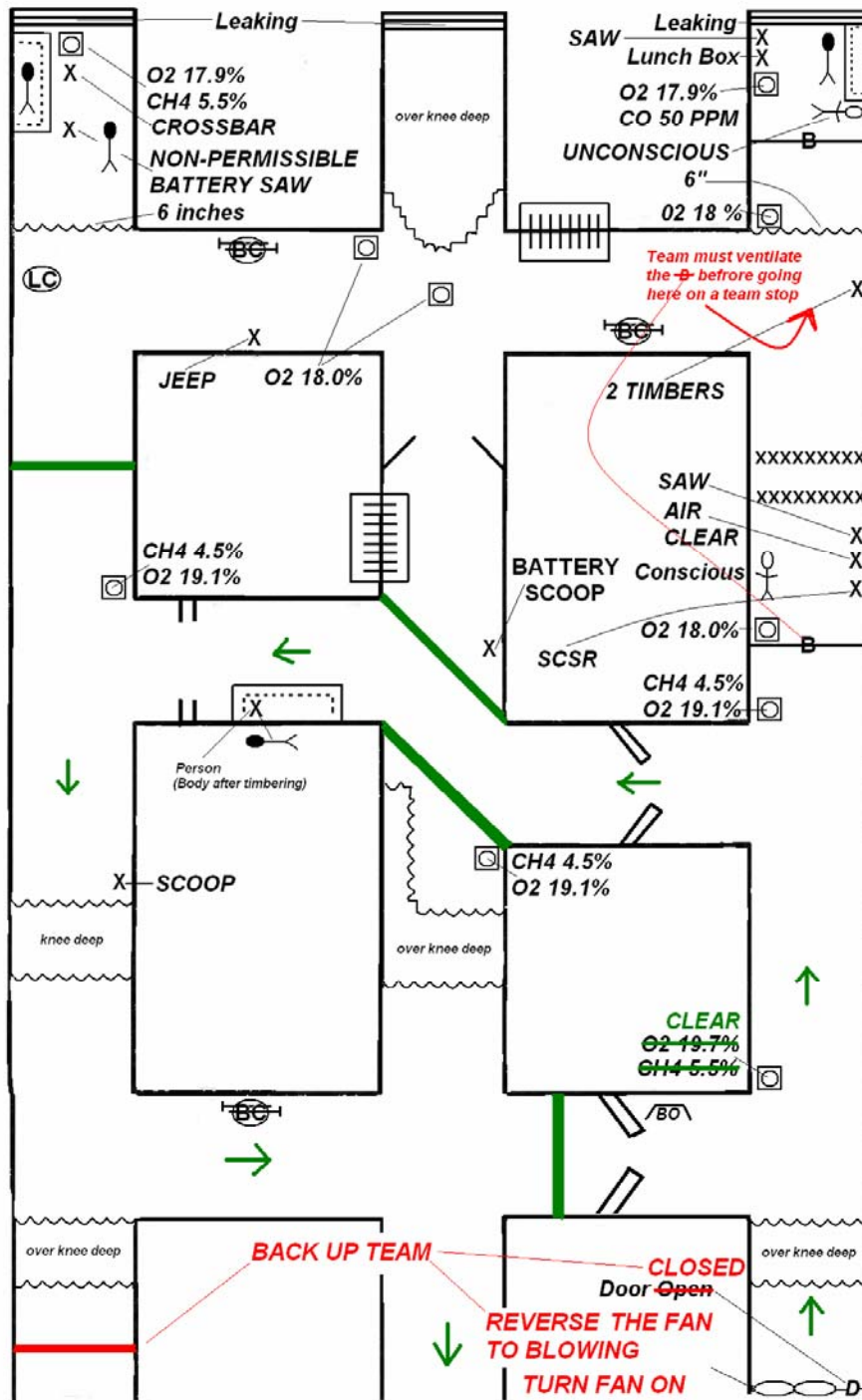

KMI 2007

2ND VENTILATION

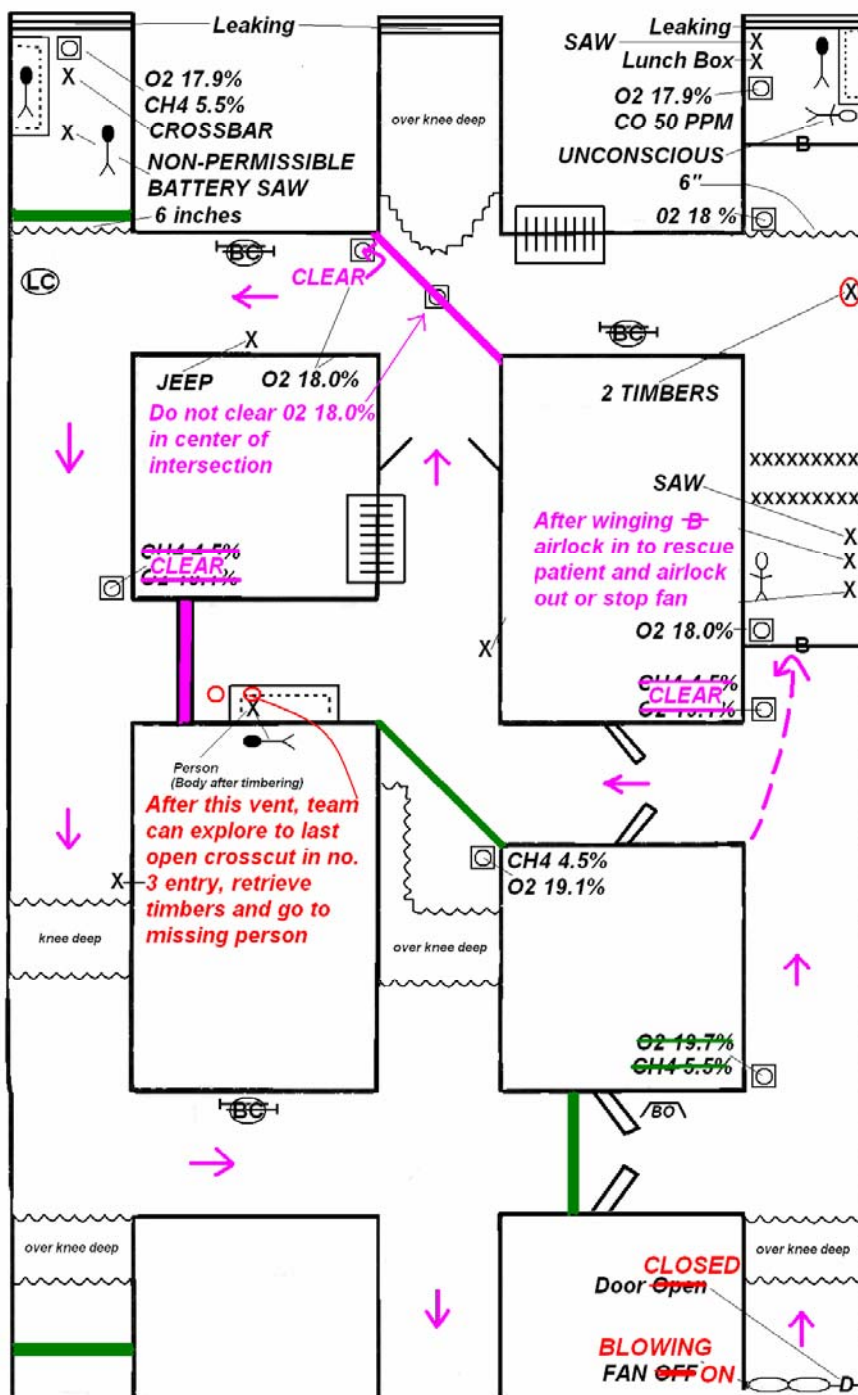

Same as second vent, but extend line curtain and build in by air clear



KMI 2007 4th Ventilation

Airlock in ~~B~~ Rescue unconv man
and FPA at explosive mixture

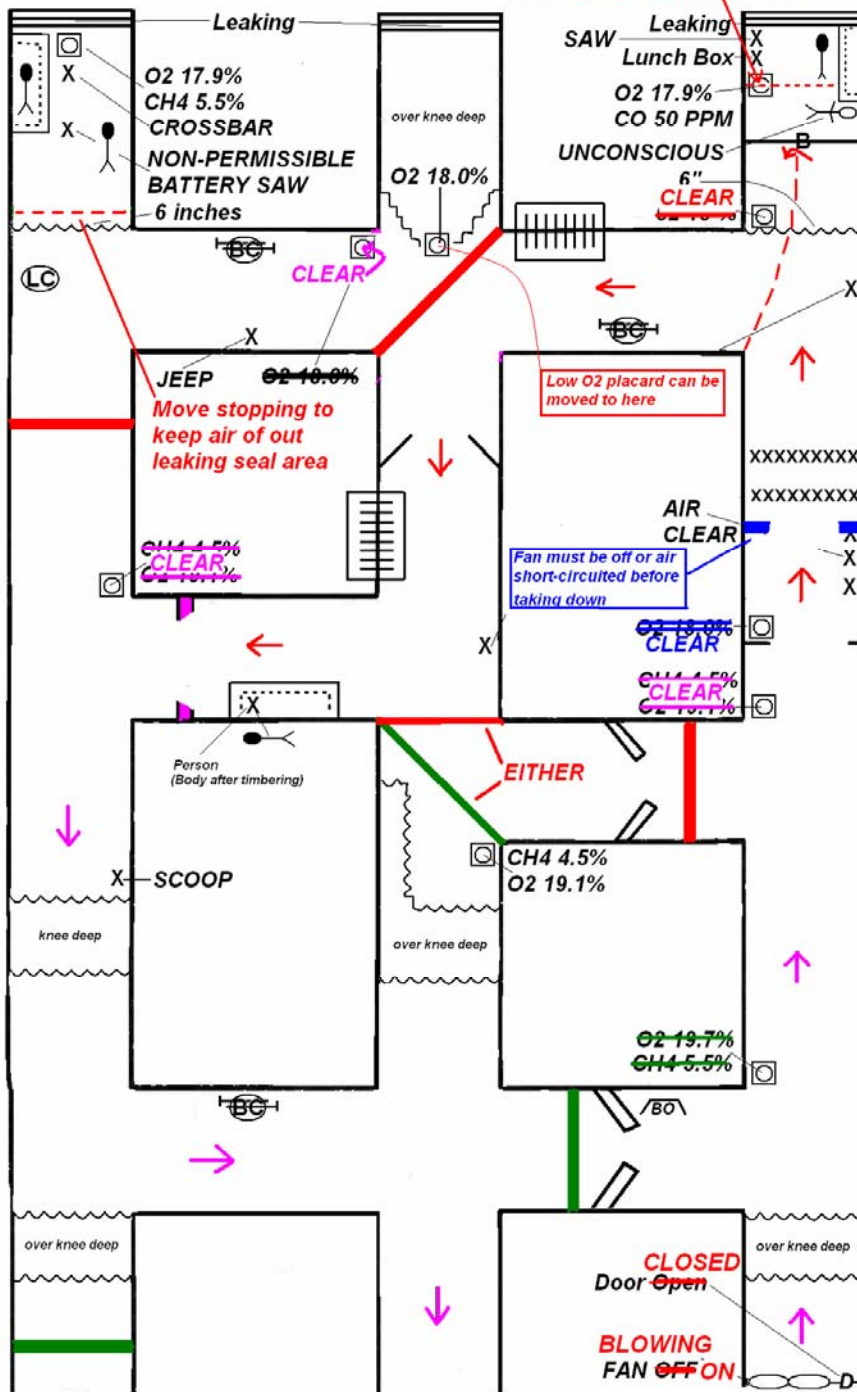

Correct outby for Superintendent

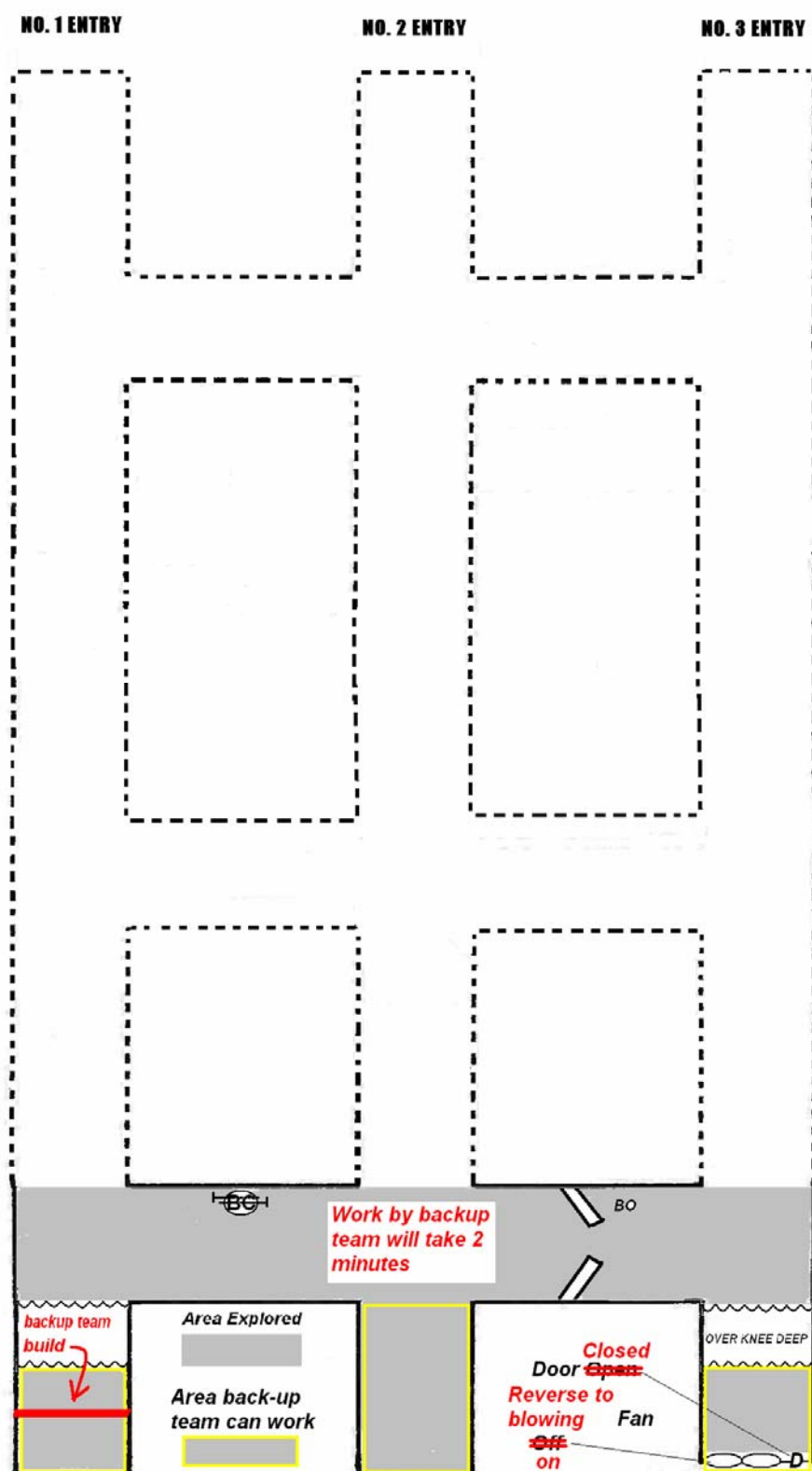

PATIENT STATEMENT

In 1st Barricade in No. 3 entry

Help ! Get me out !

Rule 31 B If team goes past evidence of fire inby Barricade

Rule 42 C If team goes to this intersection before getting patient from first barricade (Delay)

Rule 31 C - If explosive mixture is moved over seals

Rule 31 C - If explosive mixture is moved over water over knee deep

Rule 30 F - If irrespirable is moved over water over knee deep or leaking seals

Rule 30 F - If irrespirable is moved over caved area

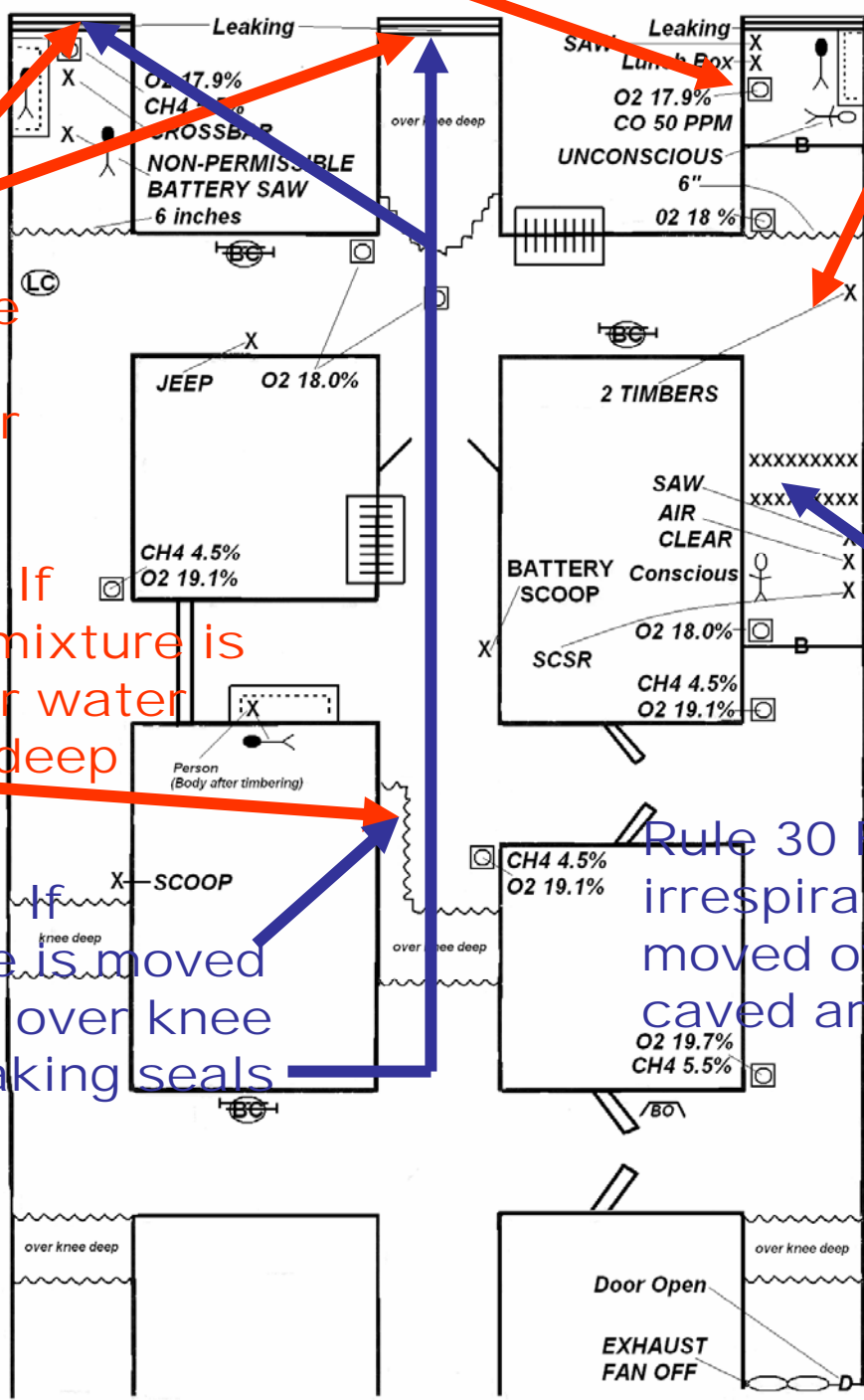

Extra Maps for Judges

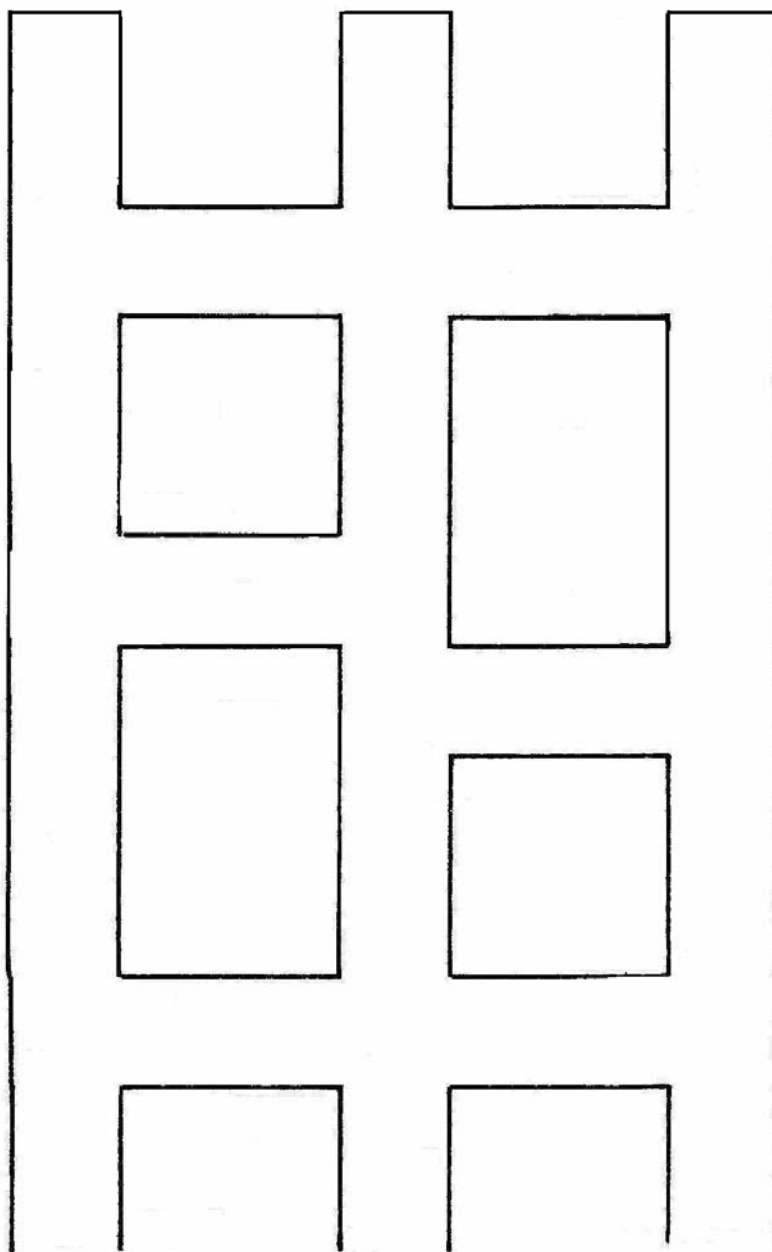

Extra Maps for Judges

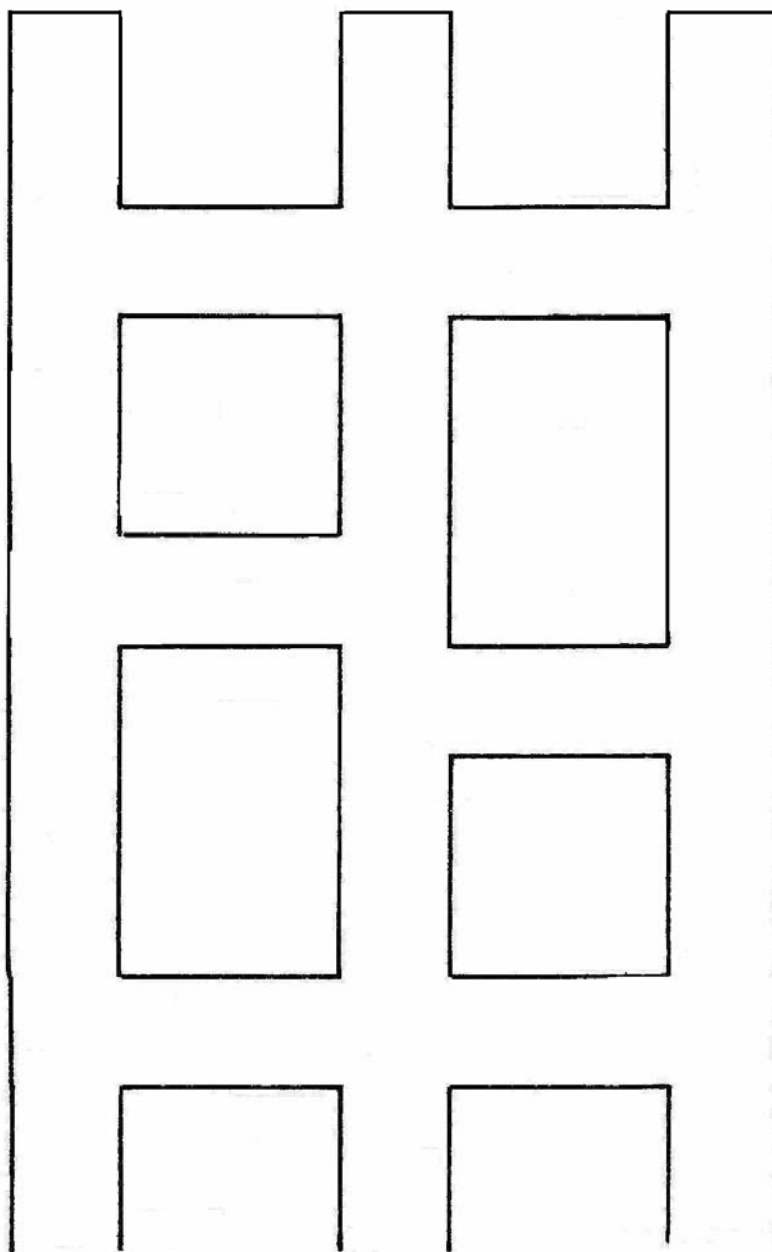

Extra Maps for Judges

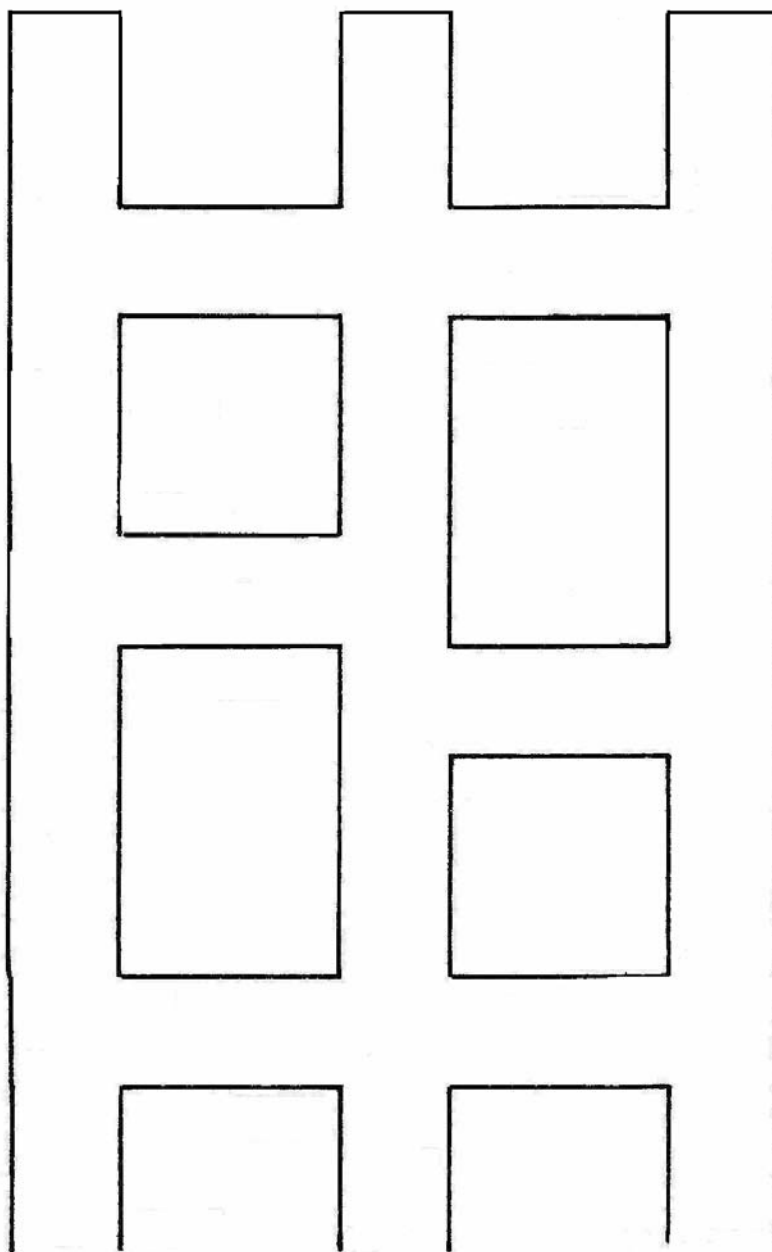

Extra Maps for Judges

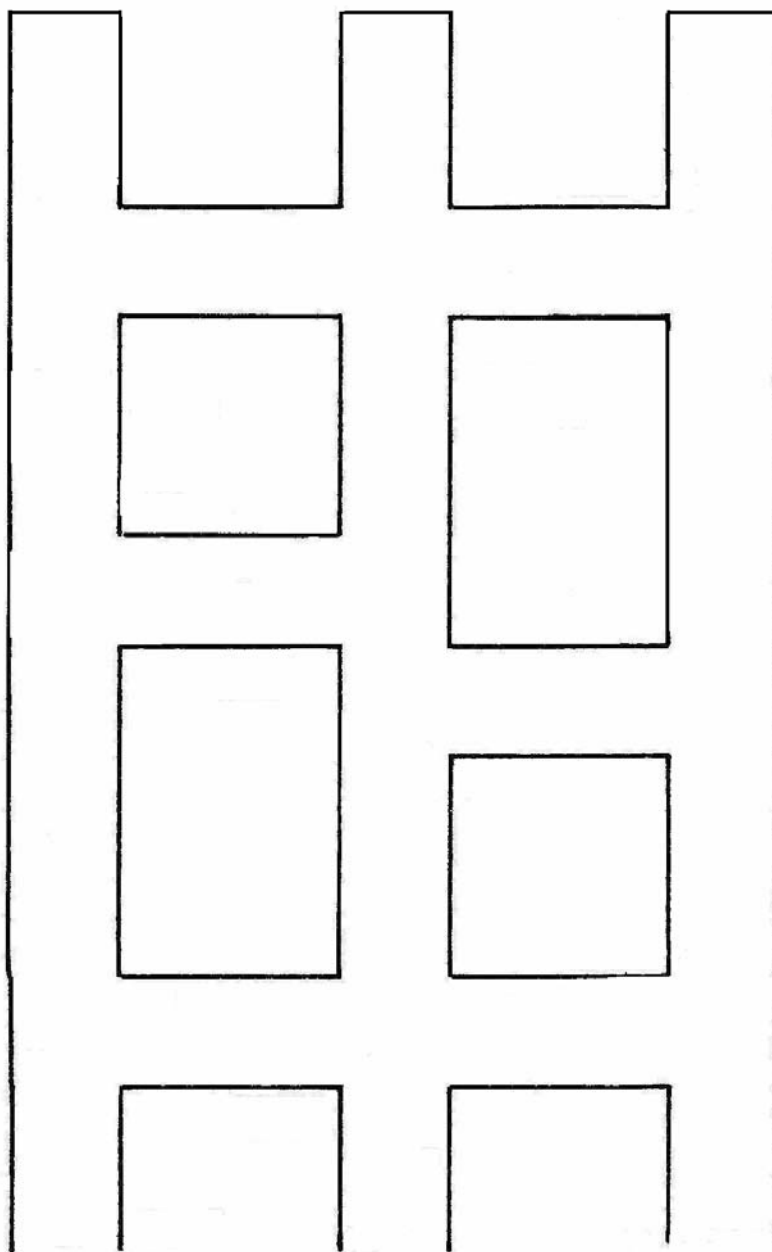

Extra Maps for Judges

